

### Signage on approach to works

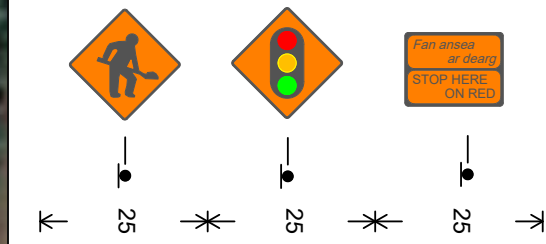

POSITIONED  
20 - 50  
METERS FROM  
WORKS AREA



### Signage on approach to works

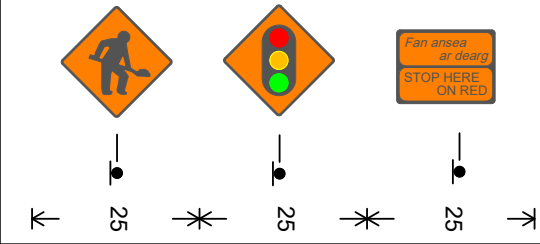

POSITIONED  
20 - 50  
METERS FROM  
WORKS AREA



Phase 2 Work Area

Existing traffic lights to be switched out/  
covered for the duration of the works

Minimum Design Parameters for Level 1 Roads - Single Carriageway 50km/h			
Design Parameter	Type A - > 12 Hours	Type B - < 12 Hours	Type C - < 15 Mins
<b>ADVANCE WARNING SIGNAGE</b>			
Sign Size (mm)	600	600	-
Sign visibility (m)	50	50	50
Number of Signs	2	2	-
Cumulative Distance (m)	40	40	-
Distance between advance signs (m)	20	20	-
<b>TAPER</b>			
Lane taper rate	1 in 5	1 in 5	-
Hard shoulder taper rate	1 in 5	1 in 5	-
<b>CONES</b>			
Cone Height (mm)	750	750	-
Taper Spacing*	3	3	-
Longitudinal Spacing (m)	3	3	-
<b>LAMPS (unit areas only)</b>			
Taper Spacing (m)	6	6	-
Longitudinal Spacing (m)	6	6	-
<b>SAFETY ZONES</b>			
Longitudinal (m)	5	5	-
Lateral (m)	0.5	0.5	-
<b>LANES</b>			
Lane width (m)	3 (2.5)	3 (2.5)	-
Two-way Roadway Width (m)	5	5	-

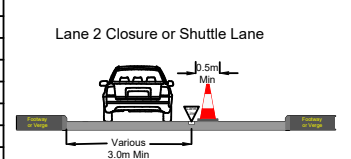

- KEY :
- Safety Zone
  - Works Area
  - Pedestrian Ramp
  - Sign Symbol
  - Pedestrian Barrier Symbol
  - Pedestrian Diversion Route

### Signage on approach to works

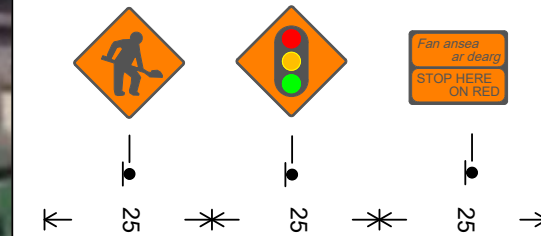

Additional signs installed throughout the site

**NOTES:**  
 1. All traffic management to be in accordance with Chapter 8 of the Traffic Signs Manual.  
 2. All signs will comply with Traffic Sign Regulations in General Directions (TSRGD) 2002  
 3. Installation, maintenance and removal of traffic management will be carried out by Lantra approved operatives who have achieved Sector Scheme 12D training/ SLG Training

R420-4 Geashill Crossroads Co.Offaly

PROJECT:  
4 way traffic lights

DRAWN: J.Lockhart

SCALE Not to scale DIMENSIONS Metres

Drg No: 004

Original Drawing Size A3

Edentober, Carrickcannon, Dundalk, Co.Louth  
T:042 9358119